

Needle Roller Bearings – Without Inner Ring

Inch Series

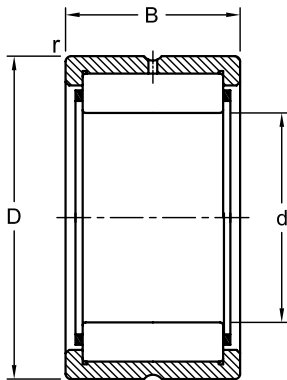

Dimensions inch (mm)				Load Rating kN		Designation
d	D	B	r	Dynamic (C)	Static (C ₀)	
0.6250	1.1250	0.7500	0.0236 (0.6)	16.2	19.1	MR 10 N
	1.1250	1.0000	0.0236 (0.6)	22.3	28.9	MR 10
0.7500	1.2500	0.7500	0.0394 (1.0)	18.7	24.0	MR 12 N
	1.2500	1.0000	0.0394 (1.0)	25.6	36.0	MR 12
0.8750	1.3750	0.7500	0.0394 (1.0)	19.8	26.7	MR 14 N
	1.3750	1.0000	0.0394 (1.0)	27.1	40.0	MR 14
1.0000	1.5000	0.7500	0.0394 (1.0)	21.8	31.6	MR 16 N
	1.5000	1.0000	0.0394 (1.0)	30.0	47.2	MR 16
1.1250	1.6250	1.0000	0.0394 (1.0)	32.5	54.3	MR 18 N
	1.6250	1.2500	0.0394 (1.0)	40.7	72.5	MR 18
1.2500	1.7500	1.0000	0.0394 (1.0)	33.6	58.3	MR 20 N
	1.7500	1.2500	0.0394 (1.0)	42.1	77.9	MR 20
1.3750	1.8750	1.0000	0.0394 (1.0)	36.0	65.4	MR 22 N
	1.8750	1.2500	0.0394 (1.0)	45.2	87.7	MR 22
1.5000	2.0625	1.5000	0.0591 (1.5)	38.5	69.0	MR 24 N
	2.0625	1.2500	0.0591 (1.5)	48.5	92.6	MR 24
1.6250	2.1875	1.0000	0.0591 (1.5)	39.4	73.0	MR 26 N
	2.1875	1.2500	0.0591 (1.5)	49.8	98.3	MR 26
1.7500	2.3125	1.0000	0.0591 (1.5)	41.8	80.5	MR 28 N
	2.3125	1.2500	0.0591 (1.5)	52.7	108.6	MR 28
1.8750	2.4375	1.0000	0.0591 (1.5)	42.9	84.6	MR 30 N
	2.4375	1.2500	0.0591 (1.5)	54.1	113.9	MR 30
1.9375	2.5000	1.2500	0.0591 (1.5)	49.8	112.1	MR 31

Dimensions inch (mm)				Load Rating kN		Designation
d	D	B	r	Dynamic (C)	Static (Co)	
2.0000	2.5625	1.0000	0.0591 (1.5)	45.2	92.1	MR 32 N
	2.5625	1.2500	0.0591 (1.5)	56.7	124.2	MR 32
2.2500	3.0000	1.5000	0.0591 (1.5)	83.9	174.0	MR 36 N
	3.0000	1.7500	0.0591 (1.5)	97.5	211.0	MR 36
2.5000	3.2500	1.5000	0.0787 (2.0)	87.9	191.0	MR 40 N
	3.2500	1.7500	0.0787 (2.0)	102.0	231.8	MR 40
2.7500	3.5000	1.5000	0.0787 (2.0)	92.1	207.8	MR 44 N
	3.5000	1.7500	0.0787 (2.0)	107.0	252.3	MR 44
3.0000	3.7500	1.5000	0.0787 (2.0)	98.3	232.7	MR 48 N
	3.7500	1.7500	0.0787 (2.0)	114.1	282.1	MR 48
3.2500	4.2520	1.7500	0.0787 (2.0)	130.8	286.6	MR 52
3.5000	4.5000	1.7500	0.0787 (2.0)	137.0	318.6	MR 56 N
	4.5000	2.0000	0.0787 (2.0)	156.6	371.6	MR 56
3.7500	4.7500	2.0000	0.0984 (2.5)	159.7	387.6	MR 60
4.0000	5.0000	2.0000	0.0984 (2.5)	165.5	417.4	MR 64
4.2500	5.2500	2.0000	0.0984 (2.5)	171.8	449.5	MR 68
4.5000	6.0000	2.2500	0.0984 (2.5)	257.7	578.5	MR 72
5.0000	6.5000	2.2500	0.0984 (2.5)	277.2	672.0	MR 80
5.5000	7.0000	2.5000	0.0984 (2.5)	286.1	755.6	MR 88 N
	7.0000	3.0000	0.0984 (2.5)	368.0	987.9	MR 88
6.0000	7.5000	2.5000	0.1181 (3.0)	313.3	787.7	MR 96 N
	7.5000	3.0000	0.1181 (3.0)	373.8	992.4	MR 96
6.5000	8.0000	2.5000	0.1181 (3.0)	316.4	814.4	MR 104 N
	8.0000	3.0000	0.1181 (3.0)	378.3	1028.0	MR 104
7.2500	9.1250	3.0000	0.1181 (3.0)	451.7	1108.0	MR 116
7.7500	9.6250	3.0000	0.1181 (3.0)	458.4	1192.6	MR 124
8.2500	10.1250	3.0000	0.1181 (3.0)	476.2	1278.0	MR 132
8.7500	10.6250	3.0000	0.1575 (4.0)	489.5	1361.7	MR 140
9.2500	11.1250	3.0000	0.1575 (4.0)	502.3	1446.2	MR 148