

# Cylindrical Roller Bearings

Single Row  
Inch Series

**CFL, CRL, CRM, LLRJ, MMRJ, XLRJ**

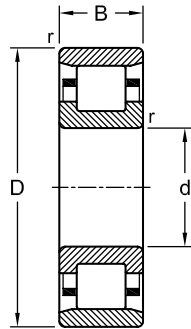

CRL / CRM / XLRJ



LLRJ / MMRJ



CFL

Dimensions				Load Rating		AEC Bearing	M
inch (mm)				kN			
d	D	B	r	Dynamic (C)	Static (C <sub>0</sub> )		
0.500	1.3125	0.3750	0.0315 (0.8)	9.85	6.95	CRL 4	
	1.3125	0.3750	0.0315 (0.8)	9.85	6.95	LLRJ 1/2	
	1.6250	0.6250	0.0630 (1.6)	17.10	12.80	CRM 4	
	1.6250	0.6250	0.0630 (1.6)	17.10	12.80	MMRJ 1/2	
0.625	1.5625	0.4375	0.0315 (0.8)	12.50	9.95	CFL 5	
	1.5625	0.4375	0.0315 (0.8)	12.50	9.95	CRL 5	
	1.5625	0.4375	0.0315 (0.8)	12.50	9.95	LLRJ 5/8	
	1.8125	0.6250	0.0630 (1.6)	18.80	14.80	CRM 5	
	1.8125	0.6250	0.0630 (1.6)	18.80	14.80	MMRJ 5/8	
0.750	1.8750	0.5625	0.0630 (1.6)	22.80	19.40	CFL 6	
	1.8750	0.5625	0.0630 (1.6)	22.80	19.40	CRL 6	•
	1.8750	0.5625	0.0630 (1.6)	22.80	19.40	LLRJ 3/4	
	2.0000	0.6875	0.0630 (1.6)	28.70	24.30	CRM 6	
	2.0000	0.6875	0.0630 (1.6)	28.70	24.30	MMRJ 3/4	
0.875	2.0000	0.5625	0.0630 (1.6)	24.60	20.80	CFL 7	
	2.0000	0.5625	0.0630 (1.6)	24.60	20.80	CRL 7	
	2.0000	0.5625	0.0630 (1.6)	24.60	20.80	LLRJ 7/8	
	2.2500	0.6875	0.0630 (1.6)	25.10	21.10	CRM 7	
	2.2500	0.6875	0.0630 (1.6)	25.10	21.10	MMRJ 7/8	
1.000	2.2500	0.6250	0.0630 (1.6)	31.10	27.90	CFL 8	
	2.2500	0.6250	0.0630 (1.6)	31.10	27.90	CRL 8	
	2.2500	0.6250	0.0630 (1.6)	31.10	27.90	LLRJ 1	
	2.5000	0.7500	0.0945 (2.4)	35.00	30.60	CFM 8	
	2.5000	0.7500	0.0945 (2.4)	35.00	30.60	CRM 8	
1.125	2.5000	0.7500	0.0945 (2.4)	35.00	30.60	MMRJ 1	
	2.5000	0.6250	0.0630 (1.6)	33.10	31.30	CFL 9	
	2.5000	0.6250	0.0630 (1.6)	33.10	31.30	CRL 9	
	2.5000	0.6250	0.0630 (1.6)	33.10	31.30	LLRJ 1.1/8	
	2.8125	0.8125	0.0945 (2.4)	45.50	41.90	CFM 9	
1.250	2.8125	0.8125	0.0945 (2.4)	45.50	41.90	CRM 9	•
	2.8125	0.8125	0.0945 (2.4)	45.50	41.90	MMRJ 1.1/8	
	2.7500	0.6875	0.0630 (1.6)	42.10	37.90	CFL 10	

Dimensions				Load Rating		AEC Bearing	M	
inch (mm)				kN				
d	D	B	r	Dynamic (C)	Static (C <sub>0</sub> )			
1.375	2.7500	0.6875	0.0630 (1.6)	42.10	37.90	CRL 10		
	2.7500	0.6875	0.0630 (1.6)	42.10	37.90	LLRJ 1.1/4		
	3.1250	0.8750	0.0945 (2.4)	58.00	52.50	CFM 10		
	3.1250	0.8750	0.0945 (2.4)	58.00	52.50	CRM 10		
	3.1250	0.8750	0.0945 (2.4)	58.00	52.50	MMRJ 1.1/4		
	3.0000	0.6875	0.0630 (1.6)	42.10	38.30	CFL 11		
	3.0000	0.6875	0.0630 (1.6)	42.10	38.30	CRL 11		
	3.0000	0.6875	0.0630 (1.6)	42.10	38.30	LLRJ 1.3/8		
1.500	3.5000	0.8750	0.0945 (2.4)	66.00	57.50	CRM 11		
	3.5000	0.8750	0.0945 (2.4)	66.00	57.50	MMRJ 1.3/8		
	2.6875	0.5625	0.0630 (1.6)	23.30	2.43	XLRJ 1.1/2		
	3.2500	0.7500	0.0945 (2.4)	54.00	48.80	CFL 12		
	3.2500	0.7500	0.0945 (2.4)	54.00	48.80	CRL 12		
	3.2500	0.7500	0.0945 (2.4)	54.00	48.80	LLRJ 1.1/2		
	3.7500	0.9375	0.0945 (2.4)	72.50	68.50	CFM 12		
	3.7500	0.9375	0.0945 (2.4)	72.50	68.50	CRM 12		
1.625	3.7500	0.9375	0.0945 (2.4)	72.50	68.50	MMRJ 1.1/2		
	2.8750	0.5625	0.0630 (1.6)	24.00	25.90	XLRJ 1.5/8		
	3.5000	0.7500	0.0945 (2.4)	57.50	54.00	CRL 13		
	3.5000	0.7500	0.0945 (2.4)	57.50	54.00	LLRJ 1.5/8		
	4.0000	0.9375	0.0945 (2.4)	85.50	83.00	CRM 13		
	4.0000	0.9375	0.0945 (2.4)	85.50	83.00	MMRJ 1.5/8		
	3.0000	0.5625	0.0630 (1.6)	24.70	27.50	XLRJ 1.3/4		
	3.7500	0.8125	0.0945 (2.4)	68.00	63.00	CFL 14		
1.750	3.7500	0.8125	0.0945 (2.4)	68.00	63.00	CRL 14		
	3.7500	0.8125	0.0945 (2.4)	68.00	63.00	LLRJ 1.3/4		
	4.2500	1.0625	0.0945 (2.4)	98.50	93.00	CFM 14		
	4.2500	1.0625	0.0945 (2.4)	98.50	93.00	CRM 14		
	4.2500	1.0625	0.0945 (2.4)	98.50	93.00	MMRJ 1.3/4		
	3.1875	0.6250	0.0630 (1.6)	34.00	35.80	XLRJ 1.7/8		
	4.0000	0.8125	0.0945 (2.4)	72.00	79.00	CRL 15		
	4.0000	0.8125	0.0945 (2.4)	72.00	79.00	LLRJ 1.7/8		
1.875	4.5000	1.0625	0.0945 (2.4)	98.50	94.50	CRM 15	•	
	4.5000	1.0625	0.0945 (2.4)	98.50	94.50	MMRJ 1.7/8		
	3.3125	0.6250	0.0630 (1.6)	35.30	38.20	XLRJ 2		
	4.0000	0.8125	0.0945 (2.4)	72.00	79.00	CFL 16		
	4.0000	0.8125	0.0945 (2.4)	72.00	79.00	CRL 16		
	4.0000	0.8125	0.0945 (2.4)	72.00	79.00	LLRJ 2		
	4.5000	1.0625	0.0945 (2.4)	98.50	94.50	CFM 16		
	4.5000	1.0625	0.0945 (2.4)	98.50	94.50	CRM 16	•	
2.000	4.5000	1.0625	0.0945 (2.4)	98.50	94.50	MMRJ 2		
	3.5625	0.6250	0.0630 (1.6)	39.10	45.00	XLRJ 2.1/4		
	4.5000	0.8750	0.0945 (2.4)	87.50	89.50	CFL 18		
	4.5000	0.8750	0.0945 (2.4)	87.50	89.50	CRL 18	•	
	2.250	4.5000	0.8750	0.0945 (2.4)	87.50	89.50	LLRJ 2.1/4	
		5.0000	1.2500	0.1260 (3.2)	136.00	138.00	CFM 18	
		5.0000	1.2500	0.1260 (3.2)	136.00	138.00	CRM 18	
		5.0000	1.2500	0.1260 (3.2)	136.00	138.00	MMRJ 2.1/4	

Dimensions				Load Rating		AEC Bearing	M
inch (mm)				kN			
d	D	B	r	Dynamic (C)	Static (C <sub>0</sub> )		
<b>2.500</b>	3.8750	0.6875	0.0630 (1.6)	42.60	52.00	XLRJ 2.1/2	
	5.0000	0.9375	0.0945 (2.4)	102.00	114.00	CFL 20	
	5.0000	0.9375	0.0945 (2.4)	102.00	114.00	CRL 20	
	5.0000	0.9375	0.0945 (2.4)	102.00	114.00	LLRJ 2.1/2	
	5.5000	1.2500	0.1260 (3.2)	164.00	167.00	CFM 20	
	5.5000	1.2500	0.1260 (3.2)	164.00	167.00	CRM 20	•
	5.5000	1.2500	0.1260 (3.2)	164.00	167.00	MMRJ 2.1/2	
<b>2.750</b>	4.1250	0.6875	0.0630 (1.6)	42.10	52.50	XLRJ 2.3/4	
	5.2500	0.9375	0.0945 (2.4)	107.00	122.00	CFL 22	
	5.2500	0.9375	0.0945 (2.4)	107.00	122.00	CRL 22	
	5.2500	0.9375	0.0945 (2.4)	107.00	122.00	LLRJ 2.3/4	
	6.2500	1.3750	0.1260 (3.2)	205.00	216.00	CFM 22	
	6.2500	1.3750	0.1260 (3.2)	205.00	216.00	CRM 22	•
	6.2500	1.3750	0.1260 (3.2)	205.00	216.00	MMRJ 2.3/4	
<b>3.000</b>	4.5000	0.7500	0.0945 (2.4)	56.00	68.50	XLRJ 3	•
	5.7500	1.0625	0.0945 (2.4)	139.00	147.00	CFL 24	
	5.7500	1.0625	0.0945 (2.4)	139.00	147.00	CRL 24	
	5.7500	1.0625	0.0945 (2.4)	139.00	147.00	LLRJ 3	
	7.0000	1.5625	0.1575 (4)	234.00	248.00	CFM 24	
	7.0000	1.5625	0.1575 (4)	234.00	248.00	CRM 24	
	7.0000	1.5625	0.1575 (4)	234.00	248.00	MMRJ 3	
<b>3.250</b>	4.7500	0.7500	0.0945 (2.4)	59.50	75.00	XLRJ 3.1/4	•
	6.0000	1.0625	0.0945 (2.4)	151.00	172.00	CFL 26	•
	6.0000	1.0625	0.0945 (2.4)	151.00	172.00	CRL 26	•
	6.0000	1.0625	0.0945 (2.4)	151.00	172.00	LLRJ 3.1/4	•
	7.5000	1.5625	0.1575 (4)	263.00	285.00	CRM 26	•
	7.5000	1.5625	0.1575 (4)	263.00	285.00	MMRJ 3.1/4	•
	7.5000	1.5625	0.1575 (4)	263.00	285.00	CRM 27	•
	7.5000	1.5625	0.1575 (4)	263.00	285.00	MMRJ 3.3/8	•
<b>3.500</b>	5.0000	0.7500	0.0945 (2.4)	60.50	78.50	XLRJ 3.1/2	•
	5.0000	0.7500	0.0945 (2.4)	60.50	78.50	XLRJA 3.1/2	•
	6.5000	1.1250	0.1260 (3.2)	168.00	189.00	CFL 28	•
	6.5000	1.1250	0.1260 (3.2)	168.00	189.00	CRL 28	•
	6.5000	1.1250	0.1260 (3.2)	168.00	189.00	LLRJ 3.1/2	•
	8.1250	1.7500	0.1575 (4)	276.00	311.00	CRM 28	•
	8.1250	1.7500	0.1575 (4)	276.00	311.00	MMRJ 3.1/2	•
	5.2500	0.7500	0.0945 (2.4)	62.00	82.50	XLRJ 3.3/4	•
	6.7500	1.1250	0.1260 (3.2)	192.00	230.00	CRL 30	•
	6.7500	1.1250	0.1260 (3.2)	192.00	230.00	LLRJ 3.3/4	•
	8.2500	1.7500	0.1575 (4)	276.00	311.00	CRM 30	•
	8.2500	1.7500	0.1575 (4)	276.00	311.00	MMRJ 3.3/4	•
<b>4.000</b>	5.6250	0.8750	0.0945 (2.4)	80.00	105.00	XLRJ 4	•
	7.2500	1.2500	0.1260 (3.2)	173.00	219.00	CFL 32	•
	7.2500	1.2500	0.1260 (3.2)	173.00	219.00	CRL 32	•
	7.2500	1.2500	0.1260 (3.2)	302.00	359.00	LLRJ 4	•
	8.5000	1.7500	0.1575 (4)	302.00	359.00	CRM 32	•
	8.5000	1.7500	0.1575 (4)	302.00	359.00	MMRJ 4	•
<b>4.250</b>	6.0000	0.8750	0.0945 (2.4)	84.00	114.00	XLRJ 4.1/4	•

Dimensions				Load Rating		AEC Bearing	M	
inch (mm)				kN				
d	D	B	r	Dynamic (C)	Static (C <sub>0</sub> )			
<b>4.500</b>	7.5000	1.2500	0.1260 (3.2)	222.00	270.00	CRL 34	•	
	7.5000	1.2500	0.1260 (3.2)	222.00	270.00	LLRJ 4.1/4	•	
	8.7500	1.7500	0.1890 (4.8)	302.00	359.00	CRM 34	•	
	8.7500	1.7500	0.1890 (4.8)	302.00	359.00	MMRJ 4.1/4	•	
	6.2500	0.8750	0.0945 (2.4)	80.00	124.00	XLRJ 4.1/2	•	
	8.0000	1.3125	0.1260 (3.2)	229.00	288.00	CRL 36	•	
	8.0000	1.3125	0.1260 (3.2)	229.00	288.00	LLRJ 4.1/2	•	
	9.3750	2.0000	0.1890 (4.8)	417.00	478.00	CRM 36	•	
<b>4.750</b>	9.3750	2.0000	0.1890 (4.8)	417.00	478.00	MMRJ 4.1/2	•	
	6.5000	0.8750	0.0945 (2.4)	92.00	133.00	XLRJ 4.3/4	•	
	8.2500	1.3125	0.1260 (3.2)	264.00	331.00	CRL 38	•	
	8.2500	1.3125	0.1260 (3.2)	264.00	331.00	LLRJ 4.3/4	•	
<b>5.000</b>	10.0000	2.0000	0.1890 (4.8)	478.00	568.00	CRM 38	•	
	10.0000	2.0000	0.1890 (4.8)	478.00	568.00	MMRJ 4.3/4	•	
	7.0000	1.0000	0.0945 (2.4)	113.00	161.00	XLRJ 5	•	
	9.0000	1.3750	0.1260 (3.2)	281.00	369.00	CRL 40	•	
	9.0000	1.3750	0.1260 (3.2)	281.00	369.00	LLRJ 5	•	
	10.0000	2.0000	0.1890 (4.8)	478.00	568.00	CRM 40	•	
<b>5.250</b>	10.0000	2.0000	0.1890 (4.8)	478.00	568.00	MMRJ 5	•	
	7.2500	1.0000	0.0945 (2.4)	112.00	161.00	XLRJ 5.1/4	•	
	<b>5.500</b>	7.5000	1.0000	0.0945 (2.4)	117.00	174.00	XLRJ 5.1/2	•
	9.5000	1.3750	0.1260 (3.2)	288.00	389.00	CRL 44	•	
<b>5.750</b>	9.5000	1.3750	0.1260 (3.2)	288.00	389.00	LLRJ 5.1/2	•	
	11.0000	2.0000	0.1890 (4.8)	545.00	668.00	CRM 44	•	
	11.0000	2.0000	0.1890 (4.8)	545.00	668.00	MMRJ 5.1/2	•	
	7.7500	1.0000	0.0945 (2.4)	122.00	186.00	XLRJ 5.3/4	•	
	<b>6.000</b>	8.0000	1.0000	0.0945 (2.4)	127.00	198.00	XLRJ 6	•
	10.5000	1.5625	0.1575 (4)	325.00	450.00	CRL 48	•	
<b>6.500</b>	10.5000	1.5625	0.1575 (4)	325.00	450.00	LLRJ 6	•	
	12.0000	2.2500	0.1890 (4.8)	640.00	795.00	CRM 48	•	
	12.0000	2.2500	0.1890 (4.8)	640.00	795.00	MMRJ 6	•	
	8.7500	1.1250	0.1260 (3.2)	131.00	211.00	XLRJ 6.1/2	•	
	11.0000	1.5625	0.1575 (4)	369.00	471.00	CRL 52	•	
	11.0000	1.5625	0.1575 (4)	369.00	471.00	LLRJ 6.1/2	•	
	13.0000	2.5000	0.1890 (4.8)	749.00	940.00	CRM 52	•	
	13.0000	2.5000	0.1890 (4.8)	749.00	940.00	MMRJ 6.1/2	•	
<b>7.000</b>	9.5000	1.2500	0.1260 (3.2)	194.00	307.00	XLRJ 7	•	
	12.0000	1.7500	0.1575 (4)	477.00	645.00	CRL 56	•	
	12.0000	1.7500	0.1575 (4)	477.00	645.00	LLRJ 7	•	
	13.5000	2.5000	0.1890 (4.8)	747.00	950.00	CRM 56	•	
<b>7.500</b>	10.0000	1.2500	0.1260 (3.2)	200.00	327.00	XLRJ 7.1/2	•	
	12.5000	1.7500	0.1575 (4)	508.00	712.00	CRL 60	•	
	12.5000	1.7500	0.1575 (4)	508.00	712.00	LLRJ 7.1/2	•	
	14.5079	2.7500	0.1890 (4.8)	838.00	1100.00	CRM 60	•	
<b>8.000</b>	10.7500	1.3750	0.1260 (3.2)	230.00	373.00	XLRJ 8	•	
	13.0000	1.7500	0.1575 (4)	537.00	779.00	CRL 64	•	
	13.0000	1.7500	0.1575 (4)	537.00	779.00	LLRJ 8	•	
	15.0000	2.7500	0.1890 (4.8)	870.00	1170.00	CRM 64	•	

Dimensions				Load Rating		AEC Bearing	M
inch (mm)				kN			
d	D	B	r	Dynamic (C)	Static (C <sub>0</sub> )		
<b>8.500</b>	11.5000	1.5000	0.1260 (3.2)	259.00	417.00	XLRJ 8.1/2	•
	14.0000	2.0000	0.1890 (4.8)	531.00	786.00	CRL 68	•
	14.0000	2.0000	0.1890 (4.8)	531.00	786.00	LLRJ 8.1/2	•
	16.0000	3.0000	0.1890 (4.8)	959.00	1280.00	CRM 68	•
<b>9.000</b>	12.0000	1.5000	0.1260 (3.2)	269.00	445.00	XLRJ 9	•
	14.5000	2.0000	0.1890 (4.8)	644.00	952.00	CRL 72	•
	14.5000	2.0000	0.1890 (4.8)	644.00	952.00	LLRJ 9	•
	17.0000	3.0000	0.1890 (4.8)	1065.00	1460.00	CRM 72	•
<b>9.500</b>	12.7500	1.6250	0.1575 (4)	313.00	521.00	XLRJ 9.1/2	•
	15.1250	2.0000	0.1890 (4.8)	556.00	856.00	CRL 76	•
	15.1250	2.0000	0.1890 (4.8)	556.00	856.00	LLRJ 9.1/2	•
	18.0000	3.2500	0.1890 (4.8)	1230.00	1640.00	CRM 76	•
<b>10.000</b>	13.2500	1.6250	0.1575 (4)	310.00	523.00	XLRJ 10	•
	15.7500	2.0000	0.1890 (4.8)	674.00	1040.00	CRL 80	•
	15.7500	2.0000	0.1890 (4.8)	674.00	1040.00	LLRJ 10	•
	18.5000	3.0000	0.1890 (4.8)	1190.00	1650.00	CRM 80	•
<b>10.500</b>	14.0000	1.7500	0.1575 (4)	373.00	640.00	XLRJ 10.1/2	•
	16.6250	2.2500	0.1890 (4.8)	671.00	1020.00	CRL 84	•
	16.6250	2.2500	0.1890 (4.8)	671.00	1020.00	LLRJ 10.1/2	•
	19.5000	3.5000	0.25 (6.35)	1330.00	1870.00	CRM 84	•
<b>11.000</b>	14.5000	1.7500	0.1575 (4)	386.00	678.00	XLRJ 11	•
	17.5000	2.2500	0.1890 (4.8)	706.00	1110.00	CRL 88	•
	17.5000	2.2500	0.1890 (4.8)	706.00	1110.00	LLRJ 11	•
	20.0000	3.5000	0.25 (6.35)	1330.00	1880.00	CRM 88	•
<b>11.500</b>	15.2500	1.8750	0.1575 (4)	423.00	736.00	XLRJ 11.1/2	•
	18.0000	2.3437	0.1890 (4.8)	839.00	1310.00	CRL 92	•
<b>12.000</b>	16.0000	2.0000	0.1890 (4.8)	477.00	836.00	XLRJ 12	•
	18.5000	2.6250	0.1890 (4.8)	858.00	136.00	CRL 96	•
	18.5000	2.6250	0.1890 (4.8)	858.00	136.00	LLRJ 12	•
	21.5000	3.7500	0.25 (6.35)	1720.00	2480.00	CRM 96	•
<b>13.000</b>	17.5000	2.2500	0.1890 (4.8)	571.00	993.00	XLRJ 13	•
	20.0000	2.7500	0.1890 (4.8)	1030.00	1680.00	CRL 104	•
	20.0000	2.7500	0.1890 (4.8)	1030.00	1680.00	LLRJ 13	•
<b>14.000</b>	18.5000	2.2500	0.1890 (4.8)	564.00	998.00	XLRJ 14	•
	21.5000	2.8750	0.1890 (4.8)	1140.00	1960.00	CRL 112	•
	21.5000	2.8750	0.1890 (4.8)	1140.00	1960.00	LLRJ 14	•
<b>15.0000</b>	20.0000	2.5000	0.1890 (4.8)	705.00	1260.00	XLRJ 15	•
	22.5000	3.0000	0.1890 (4.8)	1220.00	1940.00	CRL 120	•
	22.5000	3.0000	0.1890 (4.8)	1220.00	1940.00	LLRJ 15	•